

## DOUBLE 320

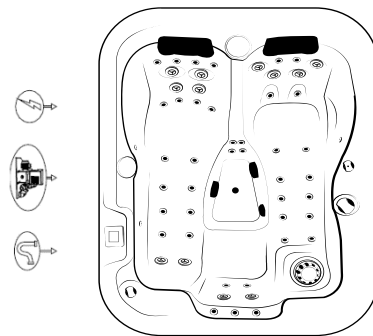

### TECHNICAL INFORMATION

Dimensions	2.10 x 1.60 x 0.82 m
Shell	Coril® White or Sterling Silver
Panels	Alupanels
Weight without water	300 Kg
Weight with water	1.250 Kg
Volume	2.8 m <sup>3</sup>

### EQUIPMENT SPECIFICATIONS

Seats	3 (2 lounged)
Filter	1 (3.25 m <sup>2</sup> )
Water Capacity	950 l
Drain Valve	1

### TECHNICAL SPECIFICATIONS

TECHNICAL SPECIFICATIONS	DELUXE
Jets	55
Circulation Pump	1 – 60 W
Massage Pump	2 – 2200 W
Blower	1 – 850 W
Disinfection system	UV & Ozone
Control box with heater	1 – 3000 W
Illumination	Multipoint

### ELECTRICAL SPECIFICATIONS

Voltage	220-240 V ~ or 380-415 V ~
Max Absorbed Power	5310 W
Frequency	50 Hz
Amperage	25A or 3x16A

Note : the standard measures may vary ±2cm

Motor compartment must have easy access.

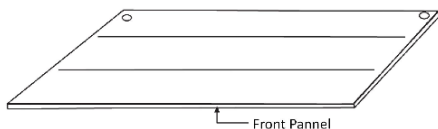
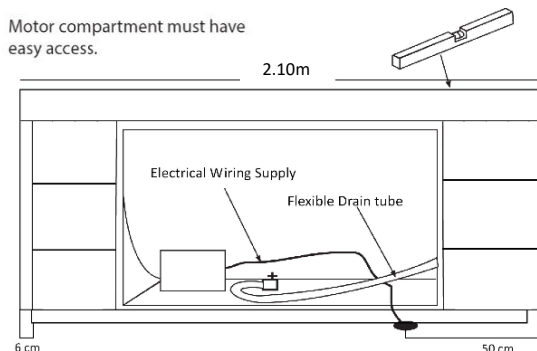

**IMPORTANT:** Important: The equipment must be connected to an exclusive and permanent power line capable to support installed power. Lighting and electrical receptacles must be located at least 1.5 meters from the equipment.

The circuit ground wire must be provided to take advantage of the designed-in safety features of the equipment.

The electric installation must be in accordance with actual legislation.